



STATE OF CONNECTICUT  
DEPARTMENT OF ENVIRONMENTAL PROTECTION



June 30, 1983

095  
8306110

Mrs. Mary Cahill  
Chairperson  
Black Point Beach Association  
Drawer 0  
Niantic, CT 06357

Re: Authorization to Establish a Restricted Swimming Area and to  
Place Markers at Black Point Beach, Niantic, CT.

Dear Mrs. Cahill:

Authorization is hereby granted to the Black Point Beach Association pursuant to Section 15-121-A5(b) of the Connecticut Boating Safety Regulations to place regulatory markers establishing restricted swimming areas at Black Point Beach in the town of East Lyme. Authorization is granted provided the markers are positioned as shown on the attached map and the following conditions are met:

1. Ten (10) restricted swimming area buoys shall be installed at the locations shown on the attached map. Distances from shore and between buoys must be followed as closely as possible;
2. Each buoy shall be a regulatory buoy with dimensions at least 9" in diameter and 61" in height (minimum 36" exposure above the surface of the water);
3. Each buoy shall be made of acrylonitrile-butadiene-styrene (ABS) filled with polyurethane foam (or equivalent) and shall have sufficient ballast to maintain proper stability and exposure (see diagram #A-1);
4. Each buoy shall be white with a 3" (silver) reflective band at the top together with restricted area symbol on two sides, the words "SWIM AREA" on two sides and a 2" orange band on top and bottom (see map and diagram #A-2);
5. Lines of barrier floats may be installed only as shown on the attached map. Barrier floats shall be no less than 12" in diameter, orange in color and made of ABS and styrofoam;
6. No barrier lines shall be installed to connect the seaward line of "restricted swim area" buoys. Except for anchor lines and the two barrier lines shown on the map, there shall be no other lines attached to the regulatory markers;

Phone: 566-7820

State Office Building, Hartford, Connecticut 06115

7. The aforementioned buoys shall be installed no earlier than May 1st and shall be removed no later than October 1st each year;
8. It shall be the responsibility of the Black Point Beach Association to install, remove and maintain the aforementioned buoys. Such maintenance shall include repairs and refurbishing as are necessary to insure visibility and stability.

In the event that any provision of this permit is violated and/or improper placement of the buoys occur, such buoys may be deemed obstructions to navigation and ordered removed pursuant to Section 15-121-A5 of the Connecticut Boating Safety Regulations.

BY AUTHORITY OF THE COMMISSIONER, DEPARTMENT OF ENVIRONMENTAL PROTECTION:



---

Dennis P. DeCarli  
Deputy Commissioner

DPD/rdd

cc: Lt. Joseph Healy, Commander, Marine District Operations  
First Selectman, Town of East Lyme

# BLACK POINT BEACH ASSOCIATION

TOWN OF EAST LYME #1

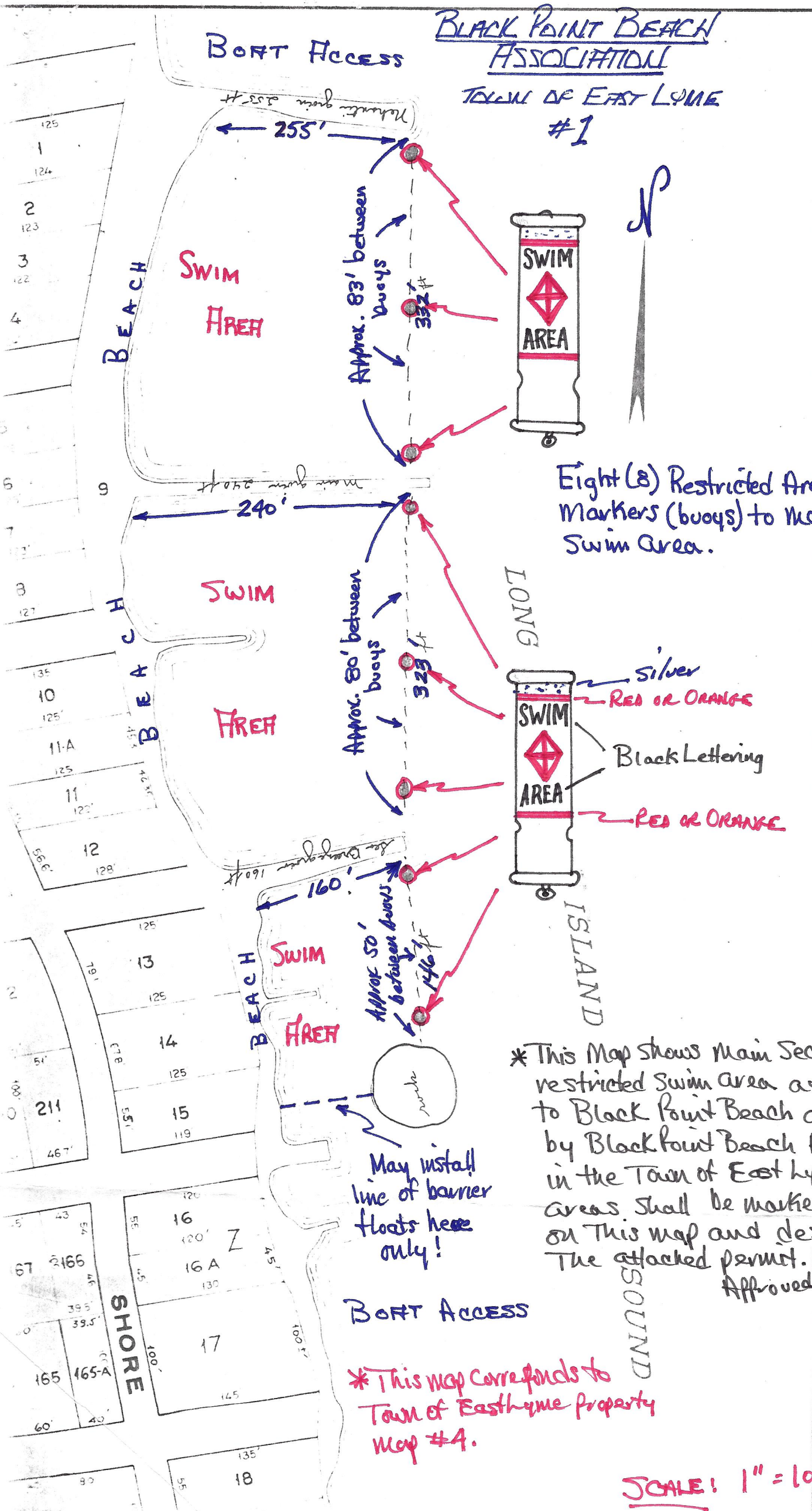

Eight (8) Restricted Area Markers (buoys) to mark Swim Area.

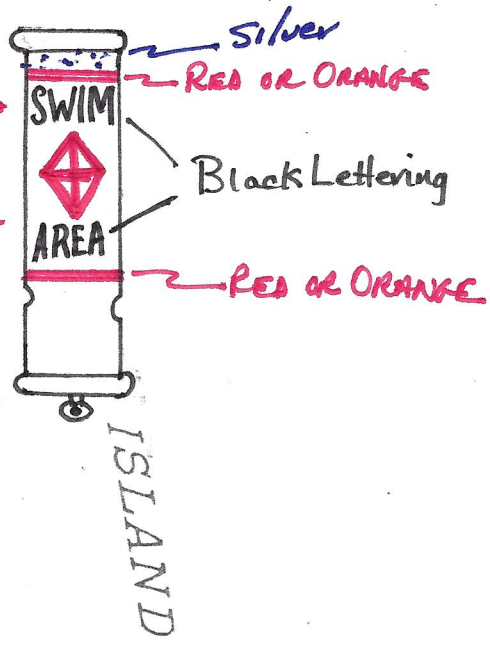

\* This Map shows Main Sections of restricted Swim Area adjacent to Black Point Beach as requested by Black Point Beach Association in the Town of East Lyme. Said Areas shall be marked as shown on this map and described in the attached permit.

Approved June 3, 1988  
KWO

BOAT ACCESS

\* This map corresponds to Town of East Lyme Property Map #4.

SCALE: 1" = 100'



# BLACK POINT BEACH ASSOCIATION

## TOWN OF EAST LYME

### #2

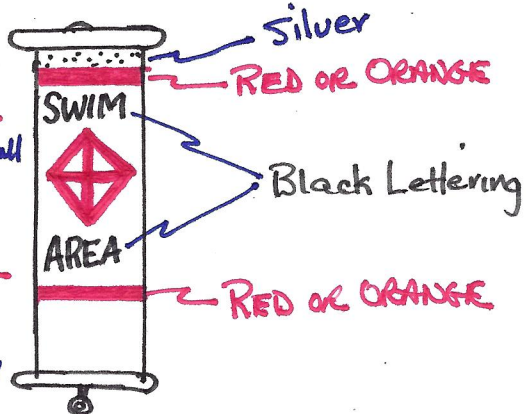
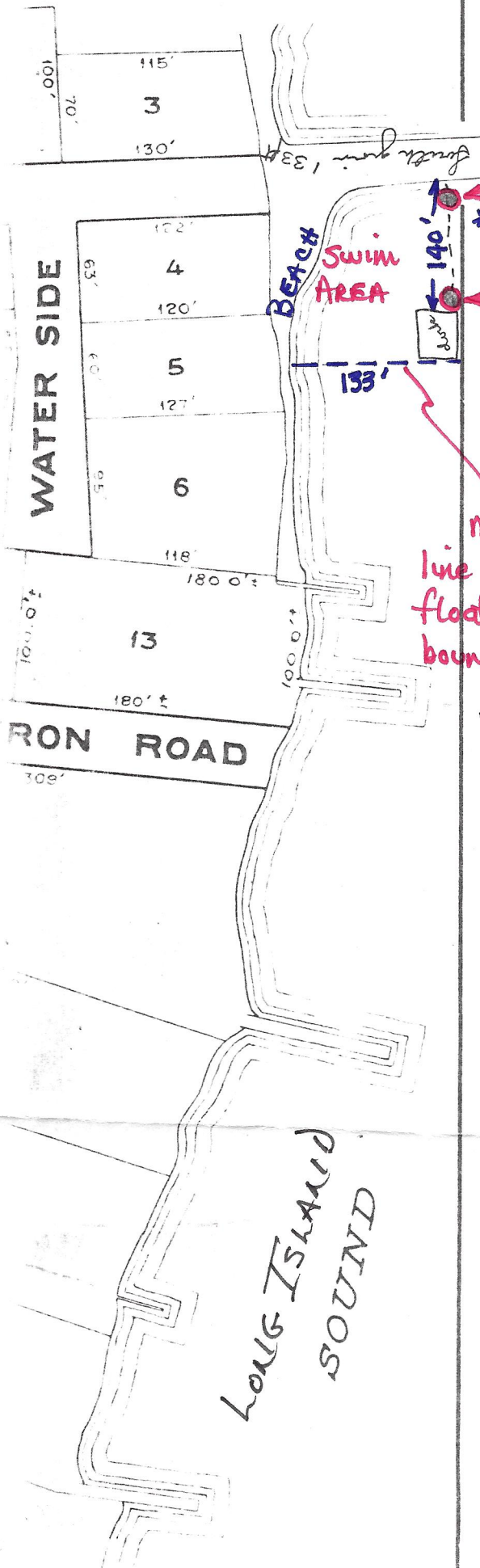

\* The two buoys shall be evenly spaced along seaward line

\* Approximately 50' apart

May install line of barrier floats along this boundary only!

Two (2) Restricted Area Markers (buoys) to mark Swim Area.

\* This Map Shows one section of a restricted swim area with approximate dimensions — 133' X 140' adjacent to Black Point Beach as requested by Black Point Beach Association in the Town of East Lyme. Said area shall be marked as shown on this map and described in the attached permit.

Approved June 30, 1983

\* This map corresponds to Town of East Lyme Property map #2.

SCALE:  
1" = 100'